

# ASSEMBLY LENGTH MEASUREMENTS FOR NAHAD HOSE ASSEMBLIES

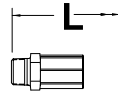

**MALE PIPE**

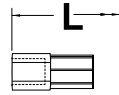

**FEMALE PIPE**

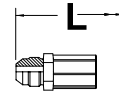

**MALE JIC  
MALE SAE  
MALE VACUSEAL  
MALE CAM LOCK**

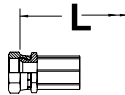

**FEMALE JIC SWIVEL  
FEMALE SAE SWIVEL**

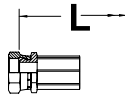

**FEMALE PIPE SWIVEL  
FEMALE BSP SWIVEL**

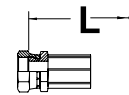

**FEMALE SEAL-LOK  
ULTRA SEAL  
FEMALE VACUSEAL  
FEMALE BEVEL SEAT**

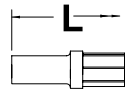

**TUBE STUB**

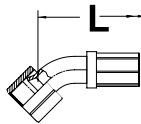

**45° Elbow Fittings**  
EX. 45° JIC/SAE  
45° SEAL-LOK  
45° BSP SWIVEL

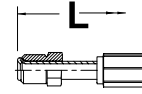

**MALE INVERTED**

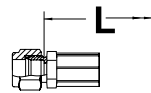

**ALOK  
CPI**

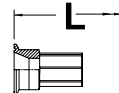

**SANITARY FLANGES  
MALE BEVEL SEAT  
FLANGE FITTINGS**

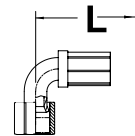

**90° Elbow Fittings**  
EX. 90° JIC/SAE  
90° SEAL-LOK  
90° BSP SWIVEL

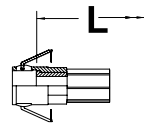

**FEMALE CAM AND GROOVE**